

NOTES:
 1. All work embraced on these plans to be done in conformity with applicable provisions of Specifications No. 2211.
 2. Exact locations of manholes, catch basins, and other structures to be shown on the field.
 3. Manholes, catch basins, and other structures to be constructed of heavy vitrified pipe and concrete, and shall conform to the provisions of Specifications No. 2211.
 4. All work shall be done in conformity with applicable provisions of Specifications No. 2211.

Barth Matic
 Survey in City of New York
 Cor. 50th St. & M. Van Ave.
 N.Y.C. 10018
 New York
 City
 Datum

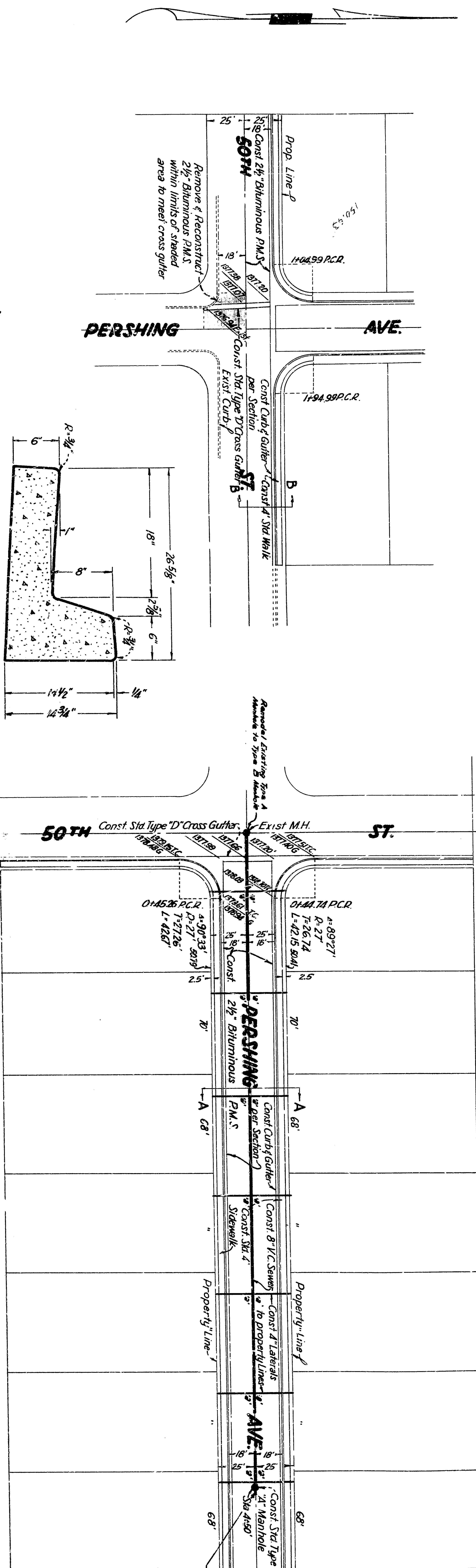

Plan Scale 1"=40'
 Show our 1 length of "B"
 V.C.P. at 1+385.75 and
 cap ends

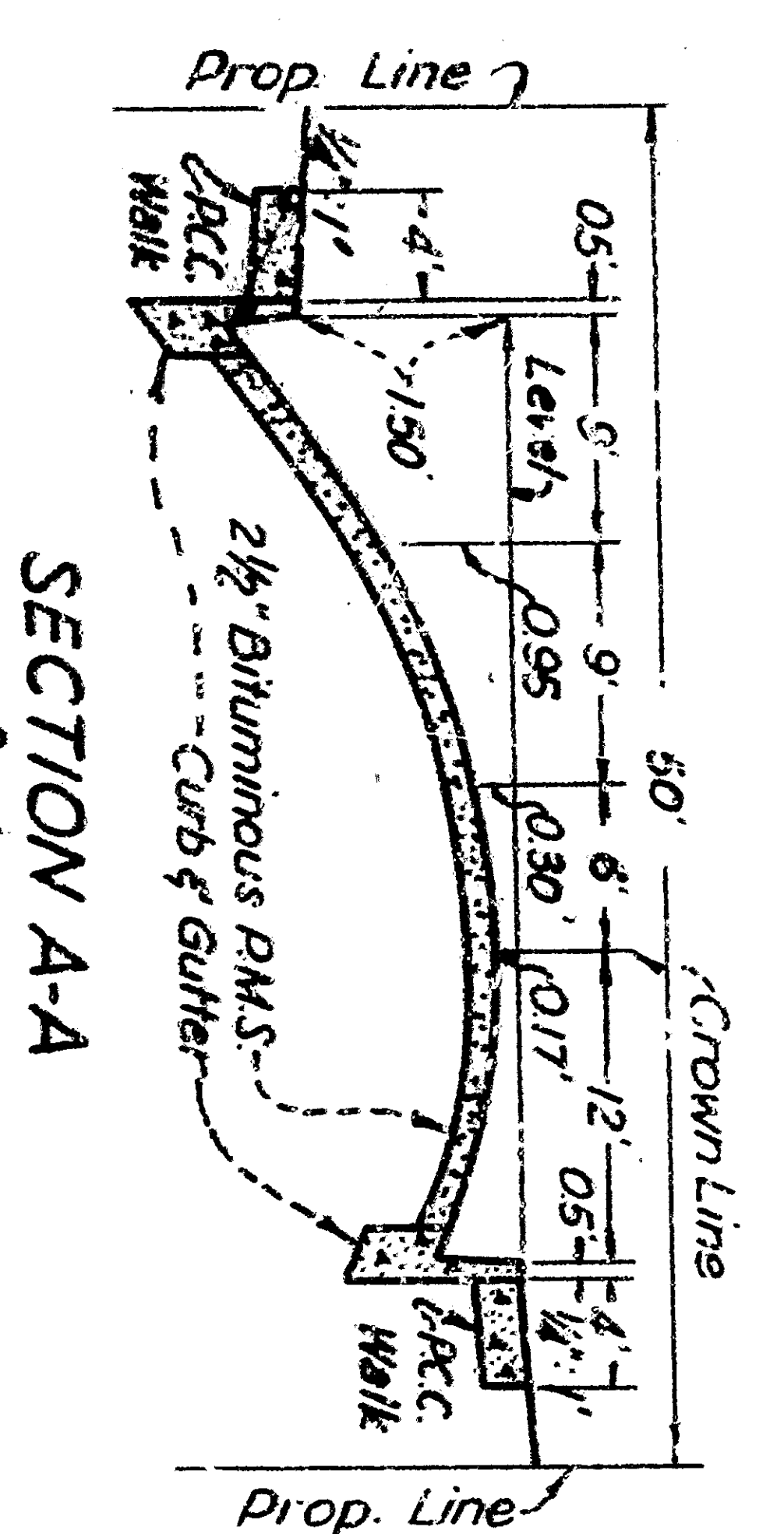
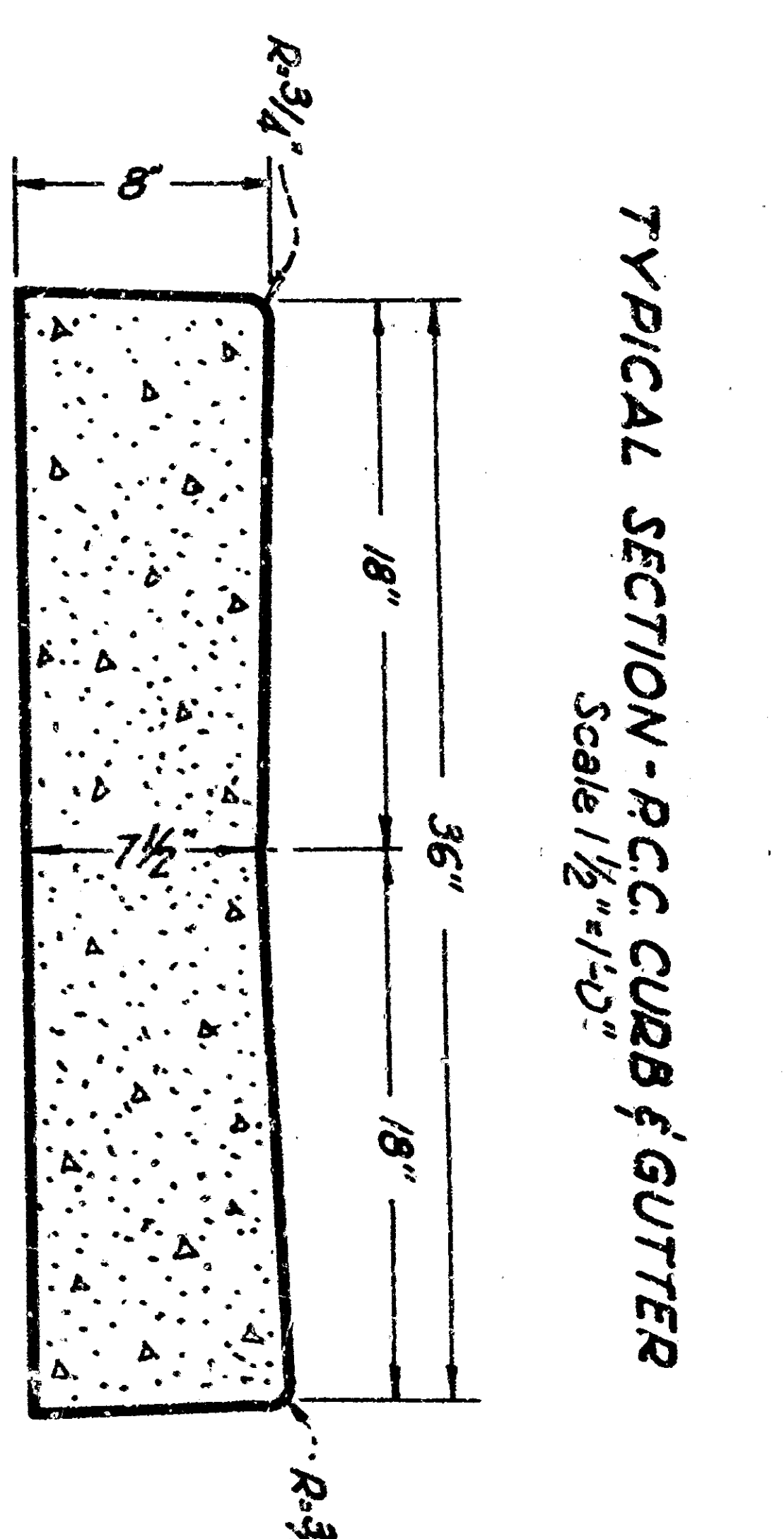
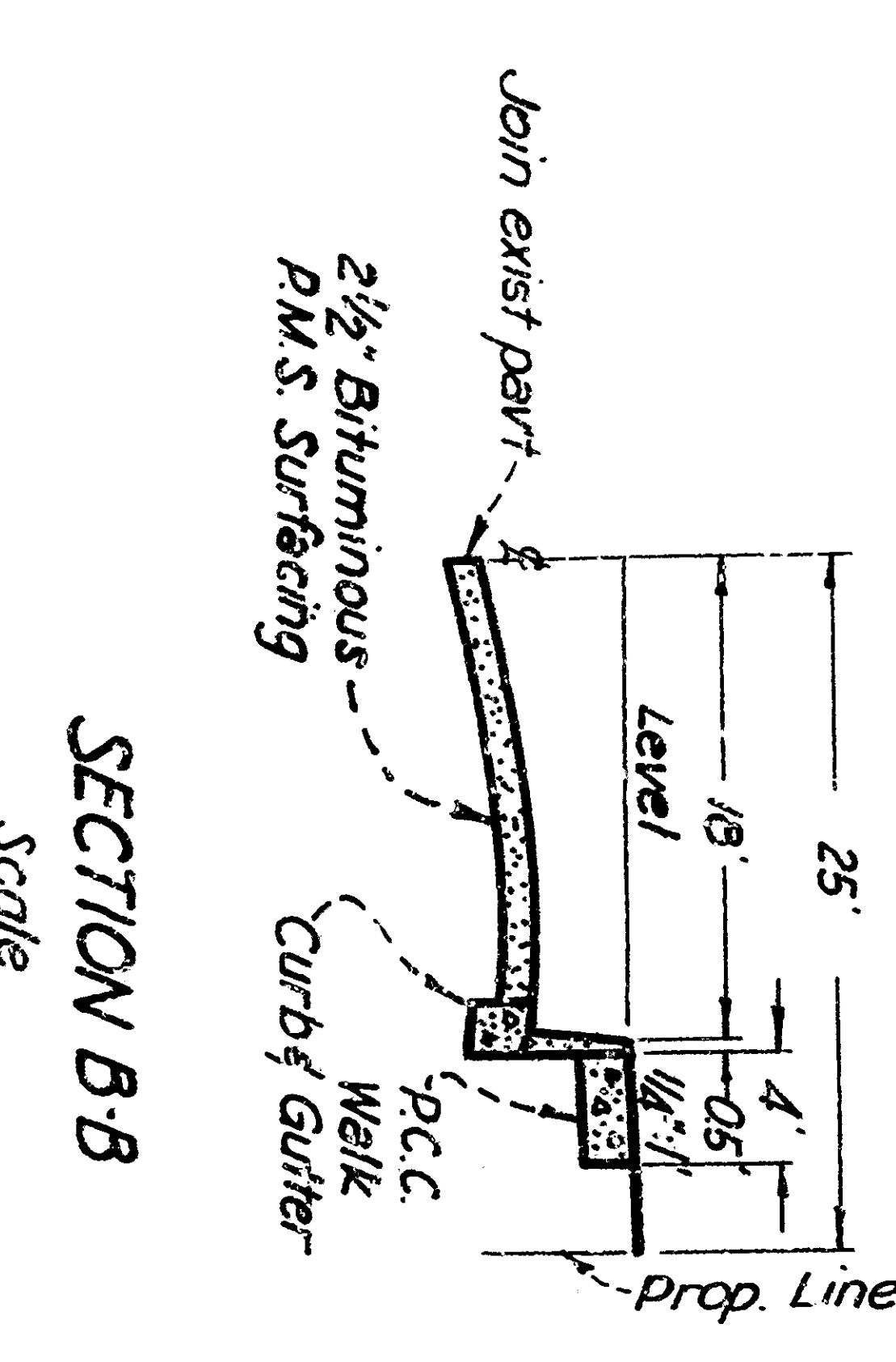

DEPARTMENT OF ENGINEERING CITY OF SAN BERNARDINO	
IMPROVEMENT PLANS TRACT NO. 4589	
DESIGNED BY: <i>[Signature]</i>	REFERENCE: OR SING NO. 2318
APPROVED: <i>[Signature]</i>	DATE: 5/27/25
DATE: April 25, 1925	DRAWN BY: D.L.C.
OFF: 387	BY: <i>[Signature]</i>
BY: VERED CIVIL ENGINEER	BY: <i>[Signature]</i>